



**DIN 2080**  
**Attacchi con cono ISO**  
*Attachments with  
ISO cone*

5

 **delta**

## 5. MANDRINI a cono ISO DIN 2080

TOOL HOLDERS with ISO cone DIN 2080



ACCESSORI PER MACCHINE UTENSILI

### DIN 2080

#### Attacchi DIN 2080

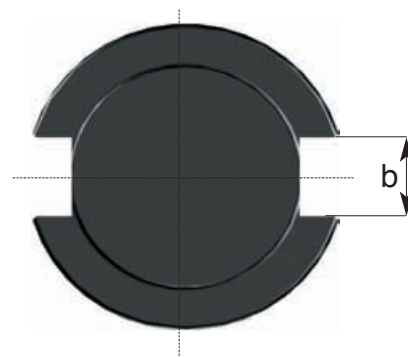
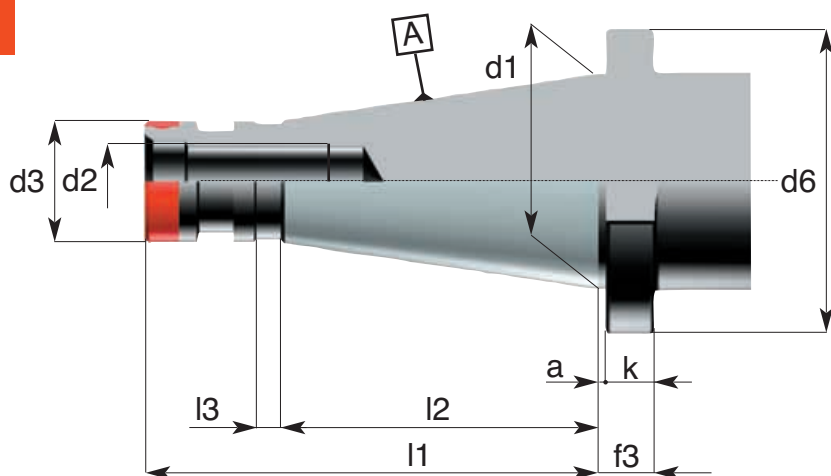

Riferimento Item	a	b H12	d1	d2	d3 H7	d6	f3	l1	l2	l3	k
ISO 30	1.6	16.1	31.75	M12	17.11	50	9.6	68.4	48.4	3	8
ISO 40	1.6	16.1	44.45	M16	25	63	11.6	93.4	65.4	5	10
ISO 50	3.2	25.7	69.85	M24	40	97.5	15.2	126.8	101.8	8	12
ISO 60	3.2	25.7	107.95	M30	60	156	19.2	206.8	161.8	10	16

#### CARATTERISTICHE TECNICHE DEI MANDRINI ISO

- Costruiti in acciaio da cementazione legato
- Cementati con profondità 0,8-1mm  
Temprati • Rinvenuti • Sabbati e bruniti
- Durezza HRC 58±2 • Resistenza al nucleo 800-1000 N/mm<sup>2</sup>
- Rettificati di precisione esternamente, internamente e nelle filettature delle ghiera chiudipinza
- Controllati con strumenti di misura certificati
- La tolleranza di precisione dei coni ISO è inferiore ad AT3

#### STANDARD FEATURES OF ISO TOOLING

- Manufactured with Nickel Chrome Molybdenum steel
- Carburized with depth of case 0,8-1 mm  
• Hardened and tempered • Black oxidized
- Surface Hardness RC 58±2 • Tensile strenght of core 800-1000 N/mm<sup>2</sup>
- Precision ground on shanks, inside tapers and collet nut threads
- Tested with high precision inspection and gaging equipment
- Taper accuracy of ISO SHANKS lower than AT3

ACCESSORI PER MACCHINE UTENSILI

Portafrese combinati con trascinamento frontale e chiave DIN 6358

Combined milling cutter chucks DIN 6358 B

Kombi-Aufsteckfräserdorne DIN 6358 B

Mandrins porte-fraises combinés DIN 6358 B

DIN 2080



ART: 130

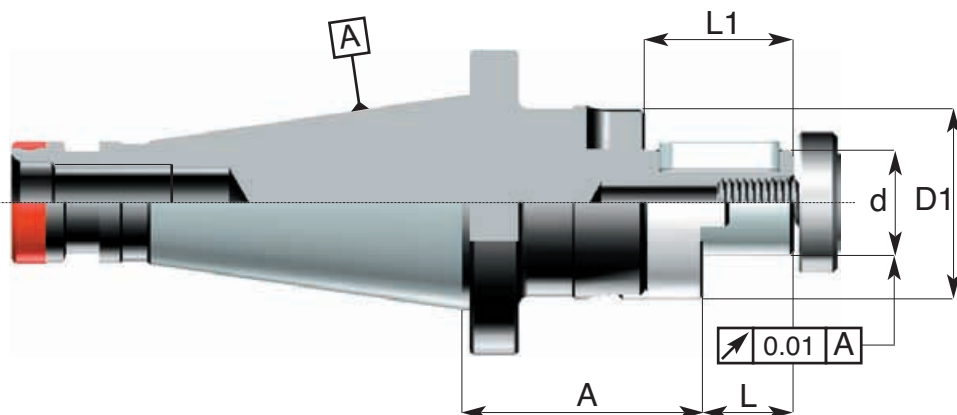
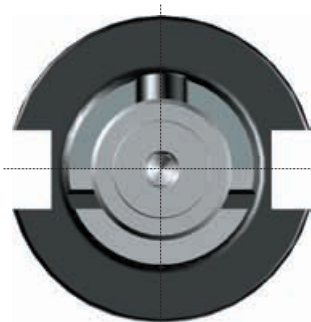

5.  
3

Codice di ord Code	SK	d h6	A	L	L1	D1	Trascinatore Ring	Vite Screw	Linguetta Key
130.30.0160	SK 30	16	42	17	27	32	190.01	191.01	130.199.01
130.30.0162	SK 30	16	75	17	27	32	190.01	191.01	130.199.01
130.30.0220	SK 30	22	45	19	31	40	190.02	191.02	130.199.02
130.30.0222	SK 30	22	75	19	31	40	190.02	191.02	130.199.02
130.30.0270	SK 30	27	46	21	33	48	190.03	191.03	130.199.03
130.30.0272	SK 30	27	71	21	33	48	190.03	191.03	130.199.03
130.40.0160	SK 40	16	45	17	27	32	190.01	191.01	130.199.01
130.40.0162	SK 40	16	90	17	27	32	190.01	191.01	130.199.01
130.40.0220	SK 40	22	50	19	31	40	190.02	191.02	130.199.02
130.40.0222	SK 40	22	90	19	31	40	190.02	191.02	130.199.02
130.40.0270	SK 40	27	50	21	33	48	190.03	191.03	130.199.03
130.40.0272	SK 40	27	90	21	33	48	190.03	191.03	130.199.03
130.40.0320	SK 40	32	50	24	38	58	190.04	191.04	130.199.04
130.40.0322	SK 40	32	105	24	38	58	190.04	191.04	130.199.04
130.40.0400	SK 40	40	59	27	41	75	190.05	191.05	130.199.05
130.40.0402	SK 40	40	105	27	41	75	190.05	191.05	130.199.05
130.50.0160	SK 50	16	52	17	27	32	190.01	191.01	130.199.01
130.50.0162	SK 50	16	105	17	27	32	190.01	191.01	130.199.01
130.50.0220	SK 50	22	58	19	31	40	190.02	191.02	130.199.02
130.50.0222	SK 50	22	105	19	31	40	190.02	191.02	130.199.02
130.50.0270	SK 50	27	56	21	33	48	190.03	191.03	130.199.03
130.50.0272	SK 50	27	105	21	33	48	190.03	191.03	130.199.03
130.50.0320	SK 50	32	56	24	38	58	190.04	191.04	130.199.04
130.50.0322	SK 50	32	105	24	38	58	190.04	191.04	130.199.04
130.50.0400	SK 50	40	58	27	41	70	190.05	191.05	130.199.05
130.50.0402	SK 50	40	105	27	41	70	190.05	191.05	130.199.05
130.50.0500	SK 50	50	61	30	46	90	190.06	191.06	130.199.06
130.50.0502	SK 50	50	120	30	46	90	190.06	191.06	130.199.06

Pag. 12.24



Pag. 12.25



## 5. MANDRINI a cono ISO DIN 2080

### TOOL HOLDERS with ISO cone DIN 2080



Alberi portafresa cono ISO DIN 6354 - 6355 per fresatrici con naso mandrino DIN 2079  
 Cutters arbors ISO DIN 6354 - 6355 cone for milling machines with DIN 2079 spindle nose  
 Längsfräsdome mit Steilkegel DIN 6354 - 6355 für Fräsmaschinen DIN 2079  
 Arbres porte-fraises à cône ISO DIN 6354 - 6355 pour fraiseuses à nez de broche DIN 2079

ACCESSORI PER MACCHINE UTENSILI

## DIN 2080



**ART: 141**

**Completì di distanziali e bussole di guida**

Delivered with guide sleeves and spacer rings  
 Geliefert mit Führungsbuchsen und Distanzstücke  
 Dotés de entretoises et douilles de guidage

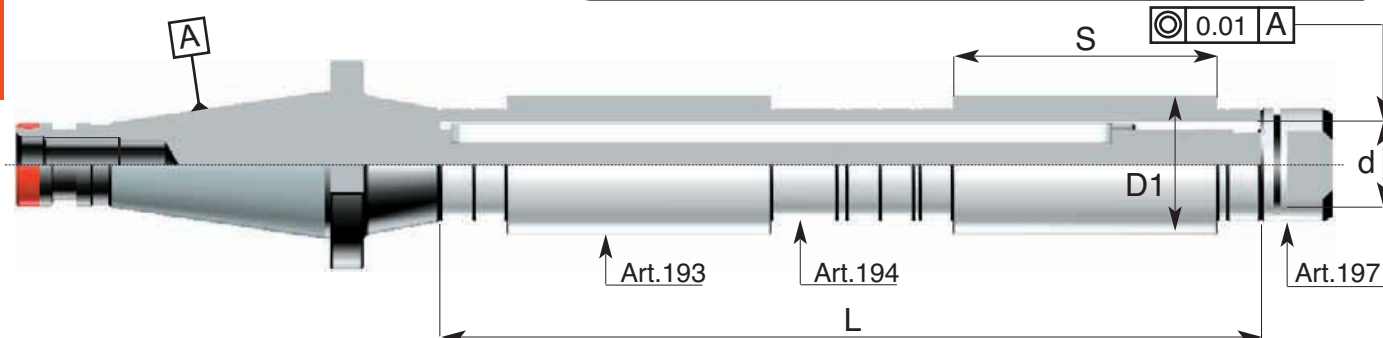

Codice di ord Code	SK	d h6	L	Ghiere Nut
141.30.0160	SK 30	16	315	19701
141.30.0162	SK 30	16	400	19701
141.30.0220	SK 30	22	315	19702
141.30.0222	SK 30	22	400	19702
141.30.0270	SK 30	27	315	19703
141.30.0272	SK 30	27	400	19703
141.40.0160	SK 40	16	315	19701
141.40.0162	SK 40	16	400	19701
141.40.0220	SK 40	22	400	19702
141.40.0222	SK 40	22	500	19702
141.40.0270	SK 40	27	400	19703
141.40.0272	SK 40	27	500	19703
141.40.0320	SK 40	32	400	19704
141.40.0322	SK 40	32	500	19704
141.40.0400	SK 40	40	400	19705
141.40.0402	SK 40	40	500	19705
141.50.0220	SK 50	22	400	19702
141.50.0222	SK 50	22	500	19702
141.50.0270	SK 50	27	400	19703
141.50.0272	SK 50	27	500	19703
141.50.0320	SK 50	32	500	19704
141.50.0322	SK 50	32	630	19704
141.50.0400	SK 50	40	500	19705
141.50.0402	SK 50	40	630	19705
141.50.0404	SK 50	40	800	19705
141.50.0500	SK 50	50	500	19706
141.50.0502	SK 50	50	630	19706
141.50.0504	SK 50	50	800	19706
141.50.0602	SK 50	60	630	19707
141.50.0604	SK 50	60	800	19707



-Nell'ordine indicare le quote D1 ed S delle bussole di guida (vd. ART. 193). Dado di bloccaggio con filetto sinistro (ART. 197).

-In order state dimensions D1 and S of guide sleeves (see ART.193). End thread and nut left hand (ART.197).

-Im Auftrag angeben die Maße D1 und S der Führungsbuchsen (ART.193). End- und Muttergewinde linksgängig (ART. 197).

-Lorsque vous passez la commande, veuillez indiquer les cotes D1 et S des douilles de guidage (voir ART. 193). Le filet terminal et l'écrou ont un filetage à gauche (ART. 197).

ACCESSORI PER MACCHINE UTENSILI

Portafrese con trascinamento frontale per frese a manicotto DIN 138  
 Face milling cutter chucks DIN 138  
 Aufsteckfräserdorne DIN 138  
 Mandrins porte-fraises à surfacer DIN 138

DIN 2080

ART: 150

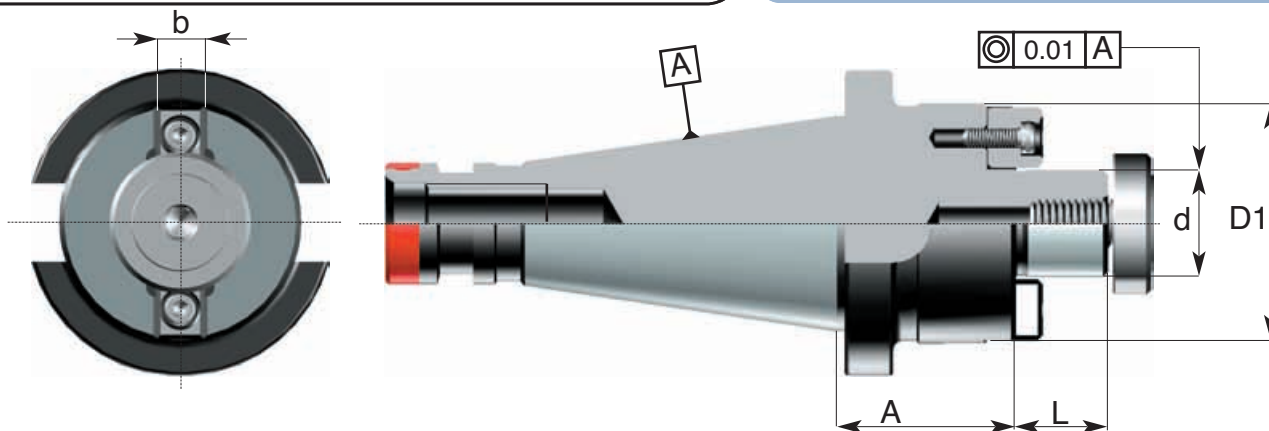

5.  
5

Codice di ord Code	SK	d h6	A	L	D1	b	Tassello Tenon	Vite Screw
150.40.0160	SK 40	16	37	17	40	8	192.06	191.01
150.40.0162	SK 40	16	100	17	40	8	192.06	191.01
150.40.0220	SK 40	22	37	19	50	10	192.07	191.02
150.40.0222	SK 40	22	100	19	50	10	192.07	191.02
150.40.0270	SK 40	27	37	21	60	12	192.08	191.03
150.40.0272	SK 40	27	100	21	60	12	192.08	191.03
150.40.0320	SK 40	32	42	24	70	14	192.09	191.04
150.40.0322	SK 40	32	100	24	70	14	192.09	191.04
150.40.0400	SK 40	40	44	27	80	16	192.10	191.05
150.40.0402	SK 40	40	100	27	80	16	192.10	191.05
150.40.0500	SK 40	50	44	31	88	18	192.11	191.06
150.40.0502	SK 40	50	100	31	88	18	192.11	191.06
150.50.0160	SK 50	16	45	17	40	8	192.06	191.01
150.50.0162	SK 50	16	120	17	40	8	192.06	191.01
150.50.0220	SK 50	22	45	19	50	10	192.07	191.02
150.50.0222	SK 50	22	120	19	50	10	192.07	191.02
150.50.0270	SK 50	27	45	21	60	12	192.08	191.03
150.50.0272	SK 50	27	120	21	60	12	192.08	191.03
150.50.0320	SK 50	32	45	24	75	14	192.09	191.04
150.50.0322	SK 50	32	120	24	75	14	192.09	191.04
150.50.0400	SK 50	40	45	27	85	16	192.10	191.05
150.50.0402	SK 50	40	120	27	85	16	192.10	191.05
150.50.0500	SK 50	50	45	31	95	18	192.11	191.06
150.50.0502	SK 50	50	120	31	95	18	192.11	191.06



## 5. MANDRINI a cono ISO DIN 2080

TOOL HOLDERS with ISO cone DIN 2080



Portafrese con trascinamento frontale e linguetta DIN 138

Face milling cutter chucks DIN 138

Aufsteckfräserdorne DIN 138

Mandrins porte-fraises à surfacer DIN 138

ACCESSORI PER MACCHINE UTENSILI

DIN 2080

ART: 151

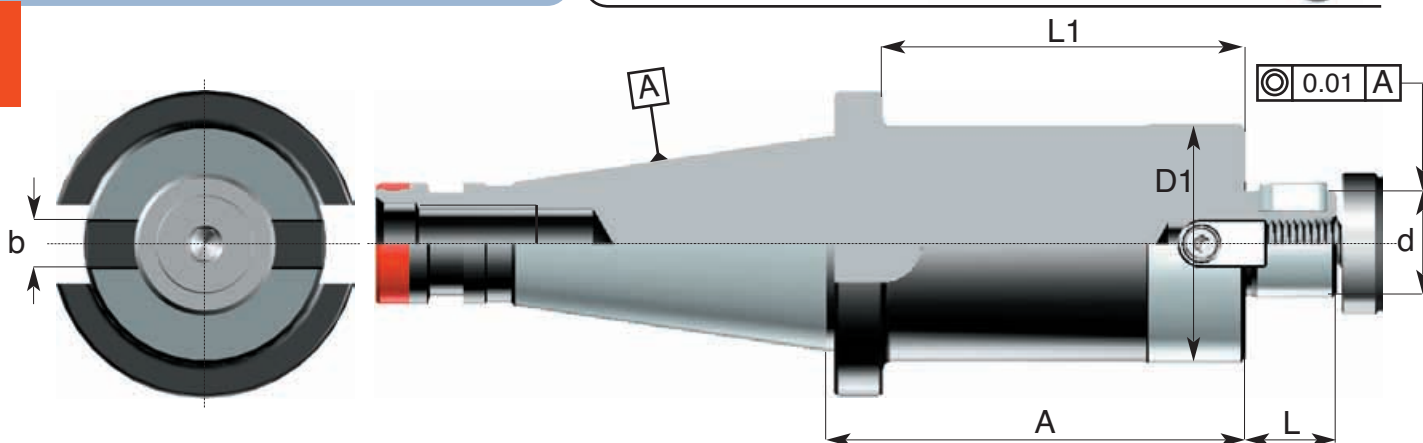

Codice di ord Code	SK	d h6	A	L	L1	D1	b	Tassello Tenon	Vite Screw	Linguetta Key
151.40.0220	SK 40	22	86	19	75	49	10	151.101	191.02	151.199.02
151.40.0222	SK 40	22	111	19	100	49	10	151.101	191.02	151.199.02
151.40.0224	SK 40	22	161	19	150	49	10	151.101	191.02	151.199.02
151.40.0226	SK 40	22	211	19	200	49	10	151.101	191.02	151.199.02
151.40.0270	SK 40	27	86	21	75	60	12	151.102	191.03	151.199.03
151.40.0272	SK 40	27	111	21	100	60	12	151.102	191.03	151.199.03
151.50.0220	SK 50	22	115	19	100	49	10	151.101	191.02	151.199.02
151.50.0222	SK 50	22	165	19	150	49	10	151.101	191.02	151.199.02
151.50.0224	SK 50	22	215	19	200	49	10	151.101	191.02	151.199.02
151.50.0225	SK 50	22	265	19	250	49	10	151.101	191.02	151.199.02
151.50.0226	SK 50	22	315	19	300	49	10	151.101	191.02	151.199.02
151.50.0228	SK 50	22	365	19	350	49	10	151.101	191.02	151.199.02
151.50.0229	SK 50	22	415	19	400	49	10	151.101	191.02	151.199.02
151.50.0270	SK 50	27	115	21	100	60	12	151.102	191.03	151.199.03
151.50.0272	SK 50	27	165	21	150	60	12	151.102	191.03	151.199.03
151.50.0274	SK 50	27	215	21	200	60	12	151.102	191.03	151.199.03
151.50.0275	SK 50	27	265	21	250	60	12	151.102	191.03	151.199.03
151.50.0276	SK 50	27	315	21	300	60	12	151.102	191.03	151.199.03
151.50.0278	SK 50	27	365	21	350	60	12	151.102	191.03	151.199.03
151.50.0279	SK 50	27	415	21	400	60	12	151.102	191.03	151.199.03



ACCESSORI PER MACCHINE UTENSILI

Portafrese con trascinamento frontale per frese a manicotto DIN 6357/B

Centering arbors for milling cutters DIN 6357 B

Aufnahmedorne für Messerköpfe DIN 6357 B

Mandrins porte-fraises pour têtes porte-lames DIN 6357 B

DIN 2080



ART: 160

5.  
7

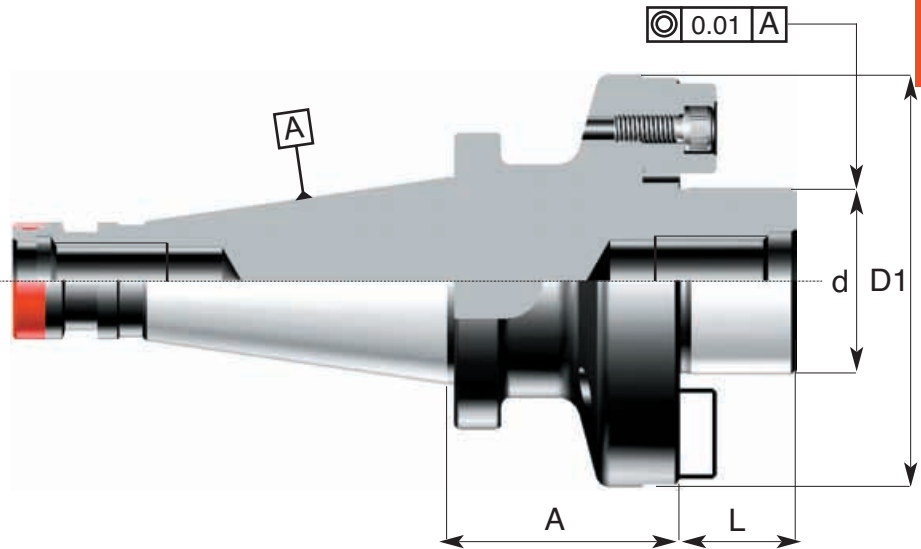
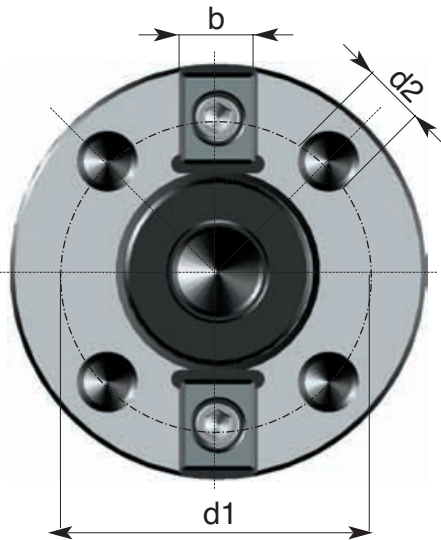

Codice di ord Code	SK	d h6	A	D1 h6	d1	d2	L	b	Tassello Tenon
160.40.0690.32	SK 40	32	50	69.832	54.00	M 10	25	15.9	192.01
160.40.0880.40	SK 40	40	50	88.882	66.70	M 12	25	15.9	192.01
160.50.0880.40	SK 50	40	60	88.882	66.70	M 12	25	15.9	192.01
160.50.1280.60	SK 50	60	67	128.570	101.6	M 16	35	25.4	192.03
160.60.0880.40	SK 60	40	75	88.882	66.70	M 12	25	15.9	192.01
160.60.1280.60	SK 60	60	75	128.570	101.6	M 16	35	25.4	192.03

Pag. 12/27



## 5. MANDRINI a cono ISO DIN 2080

TOOL HOLDERS with ISO cone DIN 2080



Portafrese cilindriche tipo weldon con vite di registrazione interna DIN 6359 B  
 Milling cutter chucks for straight-shank tools - Weldon System DIN 6359 B  
 Spannfutter Weldon für Zylinderschäfte DIN 6359 B  
 Mandrins porte-Weldon pour fraises à queue cylindrique DIN 6359 B

ACCESSORI PER MACCHINE UTENSILI



DIN 2080

ART: 208

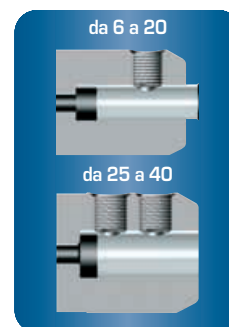
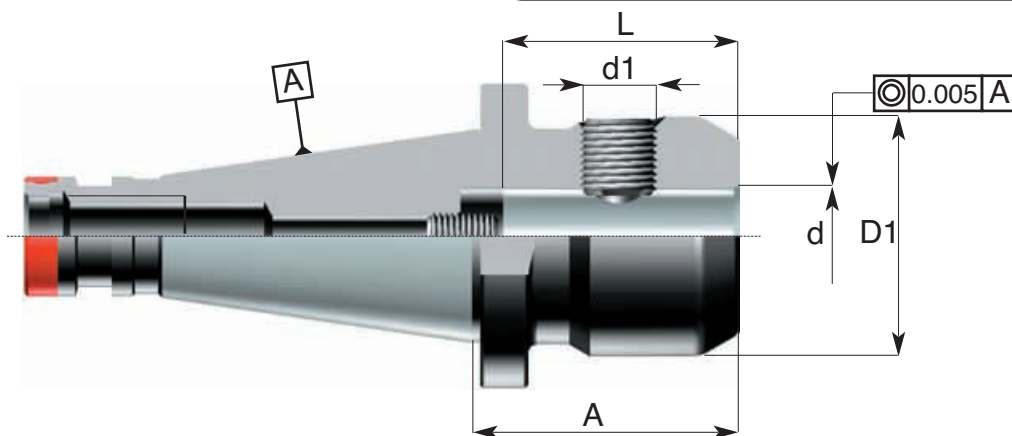

Codice di ord Code	SK	d H5	A	D1	L	d1	Grano di serraggio Clamping screw
208.30.0060	SK 30	6	40	25	35	M6X10	208.00.0060
208.30.0080	SK 30	8	40	28	35	M8X10	208.00.0080
208.30.0100	SK 30	10	40	35	39	M10X12	208.00.0100
208.30.0120	SK 30	12	45	42	44	M12X1,5X16	208.00.0120
208.30.0160	SK 30	16	50	48	47	M14X1,5X16	208.00.0140
208.30.0200	SK 30	20	63	52	49	M16X1,5X16	208.00.0160
208.40.0060	SK 40	6	50	25	35	M6X10	208.00.0060
208.40.0080	SK 40	8	50	28	35	M8X10	208.00.0080
208.40.0100	SK 40	10	50	35	39	M10X12	208.00.0100
208.40.0120	SK 40	12	50	42	44	M12X1,5X16	208.00.0120
208.40.0160	SK 40	16	63	48	47	M14X1,5X16	208.00.0140
208.40.0180	SK 40	18	63	50	47	M14X1,5X16	208.00.0140
208.40.0200	SK 40	20	63	52	49	M16X1,5X16	208.00.0160
208.40.0250	SK 40	25	85	65	54	M18X1,5X20	208.00.0180
208.40.0320	SK 40	32	90	72	58	M20X1,5X20	208.00.0200
208.50.0060	SK 50	6	50	25	35	M6X10	208.00.0060
208.50.0080	SK 50	8	50	28	35	M8X10	208.00.0080
208.50.0100	SK 50	10	50	35	39	M10X12	208.00.0100
208.50.0120	SK 50	12	50	42	44	M12X1,5X16	208.00.0120
208.50.0140	SK 50	14	63	44	44	M12X1,5X16	208.00.0120
208.50.0160	SK 50	16	63	48	47	M14X1,5X16	208.00.0140
208.50.0200	SK 50	20	63	52	49	M16X1,5X16	208.00.0160
208.50.0250	SK 50	25	80	65	54	M18X1,5X20	208.00.0180
208.50.0320	SK 50	32	80	72	58	M20X1,5X20	208.00.0200
208.50.0400	SK 50	40	90	80	68	M20X1,5X20	208.00.0200
208.50.0500	SK 50	50	100	90	78	M24X2X20	208.00.0240





ACCESSORI PER MACCHINE UTENSILI



Mandrini di centraggio cono ISO DIN 6356 per frese secondo DIN 2079  
 Centering chucks ISO DIN 6356 cone for cutters DIN 2079  
 Zentrierdörner Steilkegel ISO DIN 6356 für Messerköpfe DIN 2079  
 Mandrins de centrage à cône ISO DIN 6356 pour fraises DIN 2079

DIN 2080

ART: 230

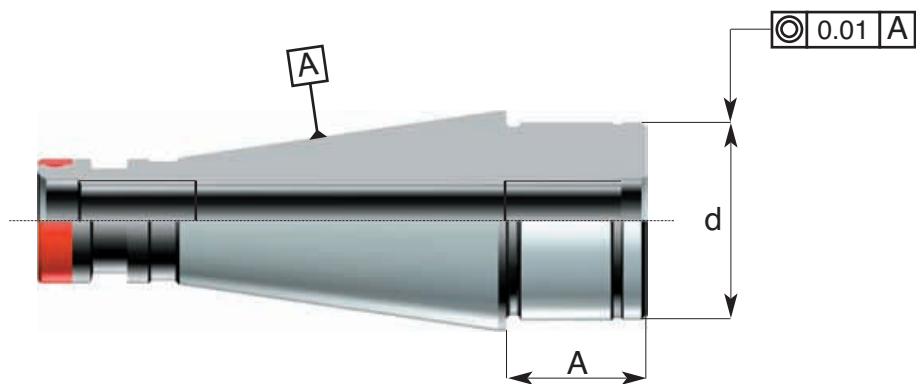

5.  
9

Codice di ord Code	SK	A	d
230.40.0320	SK 40	30	32
230.40.0400	SK 40	30	40
230.50.0500	SK 50	40	50
230.50.0600	SK 50	40	60
230.60.0600	SK 60	40	60
230.60.1000	SK 60	52	100

## 5. MANDRINI a cono ISO DIN 2080

TOOL HOLDERS with ISO cone DIN 2080



### Mandrini portamorsetti autoserranti DIN 238

Taper shafts for drill chucks DIN 238

Bohrfutteraufnahmen DIN 238

Porte-mandrins de perceuses DIN 238

ACCESSORI PER MACCHINE UTENSILI



DIN 2080

ART: 220

5.  
10

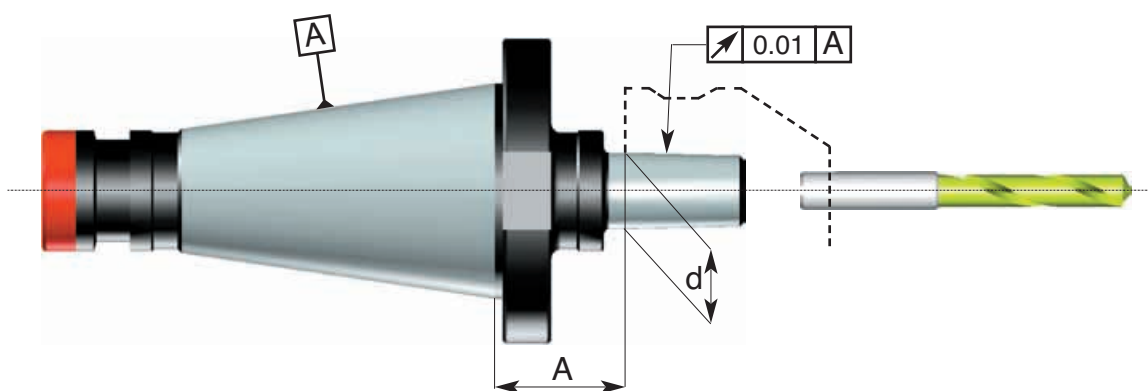

Codice di ord Code	SK	Tipo Din	A	d
220.30.0100	SK 30	B10	27	10.094
220.30.0120	SK 30	B12	27	12.065
220.30.0160	SK 30	B16	25	15.733
220.30.0180	SK 30	B18	27	17.780
220.40.0120	SK 40	B12	30	12.065
220.40.0160	SK 40	B16	30	15.733
220.40.0180	SK 40	B18	30	17.780
220.50.0160	SK 50	B16	40	15.733
220.50.0180	SK 50	B18	40	17.780
220.50.0220	SK 50	B22	40	23.827

ACCESSORI PER MACCHINE UTENSILI

Mandrini portapunte integrali  
*Integral drill chucks*  
*Kurze Bohrfutter*  
*Mandrins porte-forets intégraux*

**DIN 2080**



**ART: 221**

**5.**  
**11**

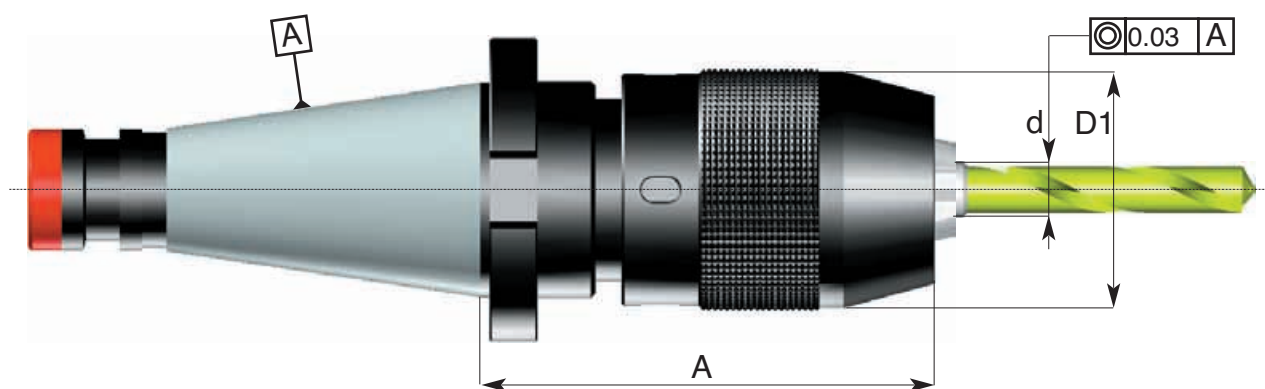

Codice di ord <i>Code</i>	SK	A	D1	capacità "d" <i>Capacity range "d"</i>
<b>221.40.1301</b>	SK 40	90	50	1-13
<b>221.40.1603</b>	SK 40	90	57	3-16
<b>221.50.1301</b>	SK 50	90	50	1-13
<b>221.50.1603</b>	SK 50	90	57	3-16

**ADATTI SOLO A ROTAZIONE DESTRA**  
**SUITABLE FOR RIGHT ROTATION ONLY**

Forniti completi di chiave  
*Supplied together with key*

## 5. MANDRINI a cono ISO DIN 2080

TOOL HOLDERS with ISO cone DIN 2080



Riduzioni da cono ISO DIN 2080 a cono ISO DIN 2080  
 Adaptors sleeves ISO DIN 2080 to ISO DIN 2080 cone  
 Zwischenhülsen ISO DIN 2080 zu ISO DIN 2080 Steilkegel  
 Douilles de réduction cône ISO DIN 2080 à ISO DIN 2080

ACCESSORI PER MACCHINE UTENSILI



DIN 2080

ART: 250

5.  
12

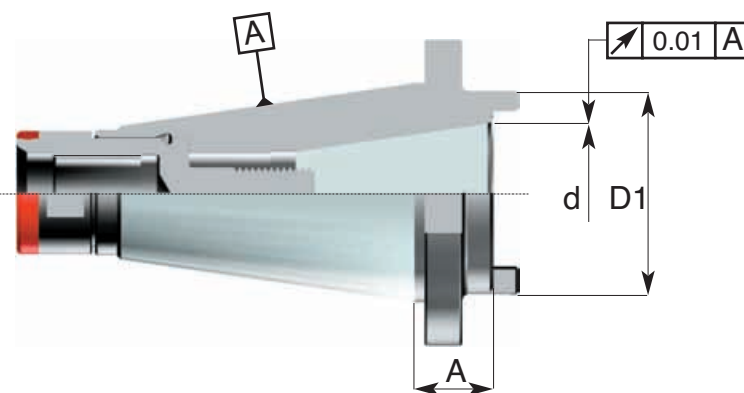
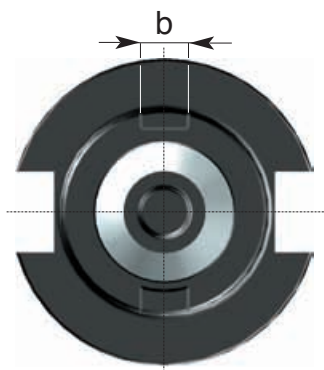

Codice di ord Code	SK	SK	d	A	D1	b	M	Codolo Pull stud
250.40.0300	SK 40	SK 30	31.750	17	51	15.9	M 12	296.01
250.45.0300	SK 45	SK 30	31.750	25	55	15.9	M 12	296.20.0120
250.45.0400	SK 45	SK 40	44.450	35	68	15.9	M 16	296.20.0160
250.50.0300	SK 50	SK 30	31.750	20	68	15.9	M 12	296.02
250.50.0400	SK 50	SK 40	44.450	25	80	15.9	M 16	296.03
250.50.0450	SK 50	SK 45	57.150	38	85	19	M 20	296.24.0200
250.60.0500	SK 60	SK 50	69.850	27	115	25.4	M 24	296.04



ACCESSORI PER MACCHINE UTENSILI

Riduzioni da cono ISO a cono ISO naso mandrino DIN 2079  
 Adaptors sleeves ISO to ISO cone with DIN 2079 spindle nose  
 Zwischenhülsen ISO zu ISO Steilkegel mit DIN 2079 Spindelkopf  
 Douilles de réduction cône ISO à cône ISO avec nez de broche DIN 2079



DIN 2080

ART: 252

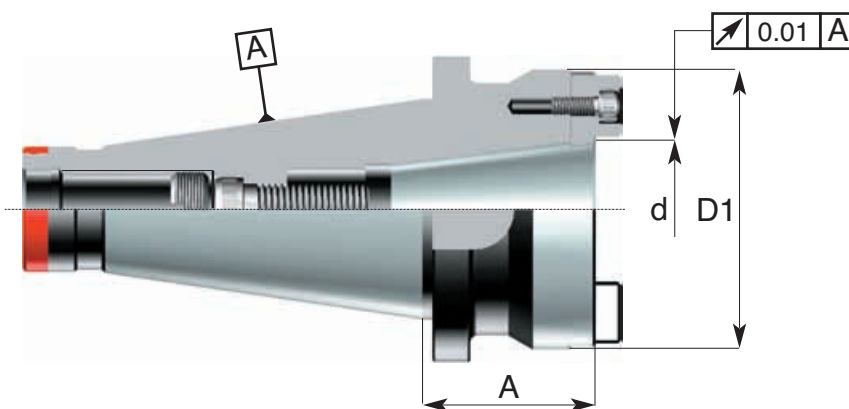
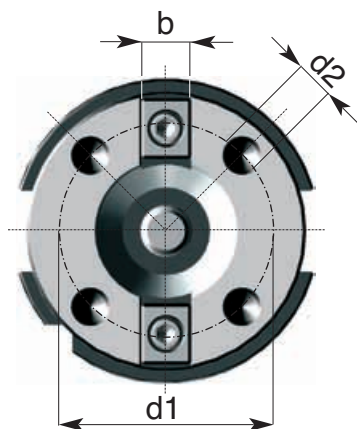

5.  
13

Codice di ord Code	SK	SK	A	D1 h6	d1	d2	b	Tassello Tenon	Vite Screw	Ghiera Nut
252.40.0400	SK 40	SK 40	75	88.882	66.70	M 12	15.90	192.02	252.00.1640.B	261.104
252.50.0300	SK 50	SK 30	53	69.832	54.00	M 10	15.90	192.01	252.00.1260.B	261.24.0300
252.50.0400	SK 50	SK 40	55	88.882	66.70	M 12	15.90	190.02	252.00.1650.B	261.24.0400
252.50.0450	SK 50	SK 45	75	101.600	80.00	M 12	19.00	191.45.0190	252.00.2050.B	252.107



Pag. 12, 26

## 5. MANDRINI a cono ISO DIN 2080

TOOL HOLDERS with ISO cone DIN 2080



Riduzioni da cono ISO a cono Morse DIN 6364 B per frese con vite interna  
 Morse taper adaptors sleeves for cutters with internal screw - DIN 6364 B  
 Zwischenhülsen für Morsekegel mit Auzugsgewinde - DIN 6364 B  
 Douilles de réduction à cône Morse pour fraises avec vis - DIN 6364 B

ACCESSORI PER MACCHINE UTENSILI



DIN 2080

ART: 261

5.  
14

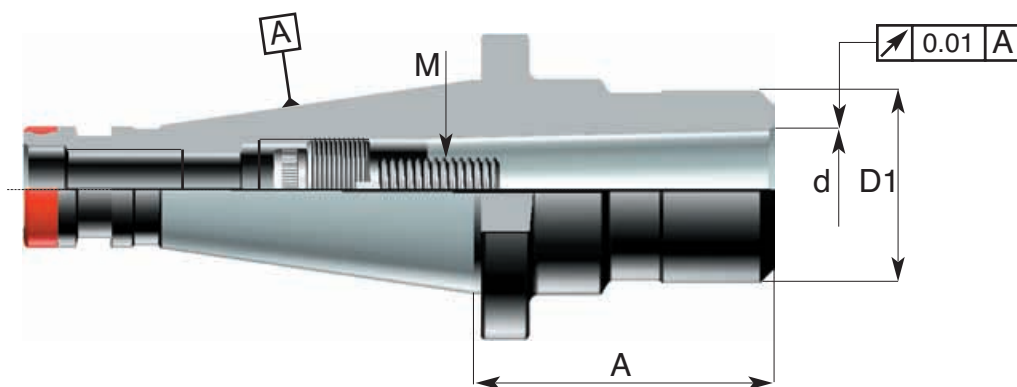

Codice di ord Code	SK	Cono Morse	d	A	D1	M	Vite Screw	Ghiera Nut
261.40.0100	SK 40	Morse 1	12.065	40	25	M 6	261.00.0630	261.16.0100
261.40.0200	SK 40	Morse 2	17.780	50	32	M 10	261.00.1035.B	261.16.0200
261.40.0300	SK 40	Morse 3	23.825	70	40	M 12	261.00.1240	261.00.1220
261.40.0400	SK 40	Morse 4	31.267	95	50	M 16	261.00.1650.E	261.00.1626
261.50.0100	SK 50	Morse 1	12.065	36	25	M 6	261.00.0645	261.24.0100
261.50.0200	SK 50	Morse 2	17.780	50	32	M 10	261.00.1040	261.24.0200
261.50.0300	SK 50	Morse 3	23.825	55	40	M 12	261.00.1240	261.24.0300
261.50.0400	SK 50	Morse 4	31.267	70	50	M 16	261.00.1645.B	261.24.0400
261.50.0500	SK 50	Morse 5	44.399	90	65	M 20	261.00.2050.E	261.00.2033



ACCESSORI PER MACCHINE UTENSILI

Riduzioni da cono ISO a cono Morse per frese con ingombri ridotti  
 Morse taper adaptors sleeves for cutters with internal screw  
 Zwischenhülsen für Morsekegel mit Auzugsgewinde  
 Douilles de réduction à cône Morse pour fraises avec vis

DIN 2080



ART: 266

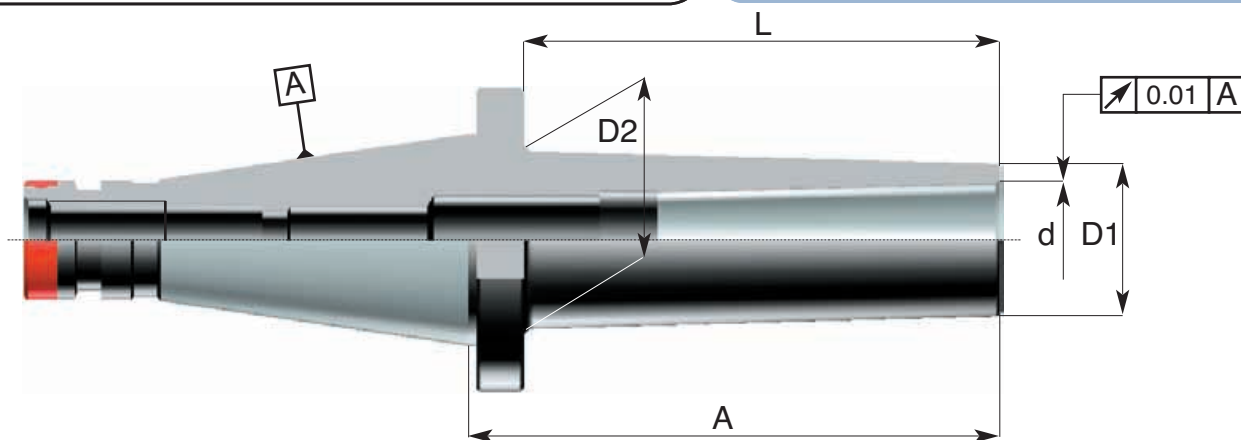

5.  
15

Codice di ord Code	SK	CM	d	A	L	D1	D2	Vite Screw	Ghiera Nut
266.40.0202	SK 40	Morse 2	17.780	111,8	100	25	30	266.00.1090.B	261.16.0200
266.40.0204	SK 40	Morse 2	17.780	161,8	150	25	33	266.00.10140.B	261.16.0200
266.40.0206	SK 40	Morse 2	17.780	211,8	200	25	35,5	266.00.10180.B	261.16.0200
266.40.0300	SK 40	Morse 3	23.825	86,8	75	32	36	266.00.1240	261.00.1220
266.40.0302	SK 40	Morse 3	23.825	111,8	100	32	37	266.00.1240	261.00.1220
266.40.0304	SK 40	Morse 3	23.825	161,8	150	32	40	266.00.1240	261.00.1220
266.40.0306	SK 40	Morse 3	23.825	211,8	200	32	42,5	266.00.1240	261.00.1220
266.50.0200	SK 50	Morse 2	17.780	115,2	100	25	30	266.00.10100	261.24.0200
266.50.0202	SK 50	Morse 2	17.780	165,2	150	25	33	266.00.10130	261.24.0200
266.50.0204	SK 50	Morse 2	17.780	215,2	200	25	35,5	266.00.10180	261.24.0200
266.50.0206	SK 50	Morse 2	17.780	265,2	250	25	38	266.00.10220	261.24.0200
266.50.0300	SK 50	Morse 3	23.825	115,2	100	32	37	266.00.12100	261.24.0300
266.50.0302	SK 50	Morse 3	23.825	165,2	150	32	40	266.00.12130	261.24.0300
266.50.0304	SK 50	Morse 3	23.825	215,2	200	32	42,5	266.00.12180	261.24.0300
266.50.0306	SK 50	Morse 3	23.825	265,2	250	32	45	266.00.12200	261.24.0300
266.50.0308	SK 50	Morse 3	23.825	315,2	300	32	48	266.00.12260	261.24.0300
266.50.0309	SK 50	Morse 3	23.825	365,2	350	32	50,5	266.00.12300	261.24.0300
266.50.0310	SK 50	Morse 3	23.825	415,2	400	32	53	266.00.12300	261.24.0300
266.50.0400	SK 50	Morse 4	31.267	115,2	100	42	47	266.00.1680.B	261.24.0400
266.50.0402	SK 50	Morse 4	31.267	165,2	150	42	50	266.00.16110.B	261.24.0400
266.50.0404	SK 50	Morse 4	31.267	215,2	200	42	52,5	266.00.16160.B	261.24.0400
266.50.0406	SK 50	Morse 4	31.267	265,2	250	42	55	266.00.16200.B	261.24.0400
266.50.0408	SK 50	Morse 4	31.267	315,2	300	42	58	266.00.16260.B	261.24.0400
266.50.0409	SK 50	Morse 4	31.267	365,2	350	42	60,5	266.00.16300.B	261.24.0400



## 5. MANDRINI a cono ISO DIN 2080

### TOOL HOLDERS with ISO cone DIN 2080



Riduzioni da cono ISO a cono Morse per punte tipo normale e prolungato

Adaptors sleeves from ISO cone to Morse cone for tools with driving shank

Zwischenhülsen mit Steilkegel für Werkzeuge mit Morsekegel und Austreibklappen

Douilles de réduction de cône ISO à cône Morse pour outils munies de dents d'entraînement

ACCESSORI PER MACCHINE UTENSILI



DIN 2080

ART: 262

5.  
16

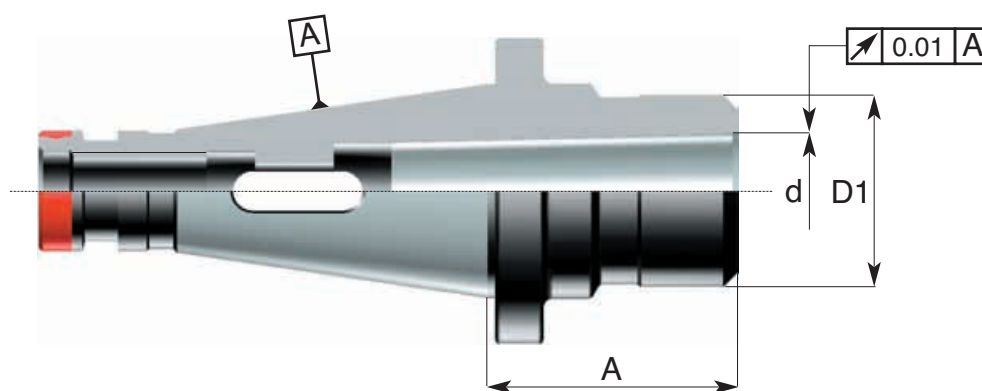

Codice di ord Code	SK	Cono Morse	d	A	D1	Combi*
262.30.0100	SK 30	Morse 1	12.065	35	25	PF
262.30.0102	SK 30	Morse 1	12.065	100	20	-
262.30.0200	SK 30	Morse 2	17.780	47	30	-
262.30.0202	SK 30	Morse 2	17.780	115	30	-
262.30.0300	SK 30	Morse 3	23.825	75	35	-
262.30.0302	SK 30	Morse 3	23.825	135	38	-
262.40.0100	SK 40	Morse 1	12.065	32	25	PF
262.40.0200	SK 40	Morse 2	17.780	35	30	PF
262.40.0202	SK 40	Morse 2	17.780	115	30	PF
262.40.0300	SK 40	Morse 3	23.825	52	40	PF
262.40.0302	SK 40	Morse 3	23.825	140	38	-
262.40.0400	SK 40	Morse 4	31.267	80	50	-
262.40.0402	SK 40	Morse 4	31.267	160	48	-
262.40.0502	SK 40	Morse 5	44.399	195	60	-
262.50.0100	SK 50	Morse 1	12.065	35	35	PF
262.50.0200	SK 50	Morse 2	17.780	40	35	PF
262.50.0202	SK 50	Morse 2	17.780	125	30	PF
262.50.0300	SK 50	Morse 3	23.825	45	40	PF
262.50.0302	SK 50	Morse 3	23.825	145	40	PF
262.50.0400	SK 50	Morse 4	31.267	55	50	PF
262.50.0402	SK 50	Morse 4	31.267	175	50	PF
262.50.0500	SK 50	Morse 5	44.399	85	65	-
262.50.0502	SK 50	Morse 5	44.399	205	65	-
262.50.0600	SK 50	Morse 6	63.348	190	85	-
262.50.0602	SK 50	Morse 6	63.348	265	85	-

\*Le riduzioni PF sono adatte anche per frese con attacco DIN 228-A; per i tipi ISO 30 CM2-3, ISO 40 CM3-4, ISO 45 CM5 e ISO 50 CM5 è necessario l'uso del tirante lungo (vedi sezione tiranti)

\*PF adaptors are suitable for clamping mills with MT-shank; for ISO 30 MK2-3, ISO 40 MK3-4, ISO 45 MK5 e ISO 50 MK5 is necessary the long pull stud (see pull studs section)



ACCESSORI PER MACCHINE UTENSILI

Barre semifinite con tratto cilindrico privo di cementazione per esecuzioni speciali  
 Unfinished taper-shank blanks for special applications  
 Rohlinge für spezielle Anwendungen  
 Ebauches pour applications spéciales

DIN 2080

ART: 424

5.  
17

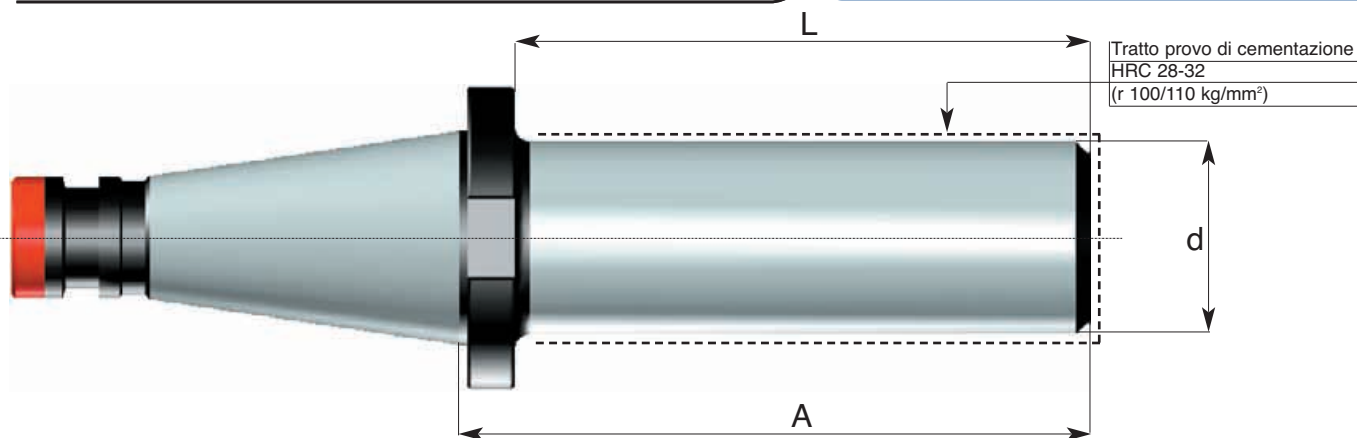

Codice di ord Code	SK	d	A	L
424.40.0402	SK 40	40	182	170
424.40.0404	SK 40	40	262	250
424.40.0630	SK 40	63	162	150
424.40.0632	SK 40	63	262	250
424.50.0502	SK 50	50	225	210
424.50.0504	SK 50	50	330	315
424.50.0632	SK 50	63	265	250
424.50.0634	SK 50	63	415	400
424.50.1000	SK 50	97	265	250
424.50.1002	SK 50	97	415	400

## 5. MANDRINI a cono ISO DIN 2080

TOOL HOLDERS with ISO cone DIN 2080



### Mandrini portapinze Delta per pinze rif. art.209

Delta collet chucks for collets ref. art.209

Delta Spannzangenhalter für Spannzangen ref. art.209

Mandrins porte-pinces Delta pour pinces ref. art.209

ACCESSORI PER MACCHINE UTENSILI

DIN 2080

ART: 200



5.18

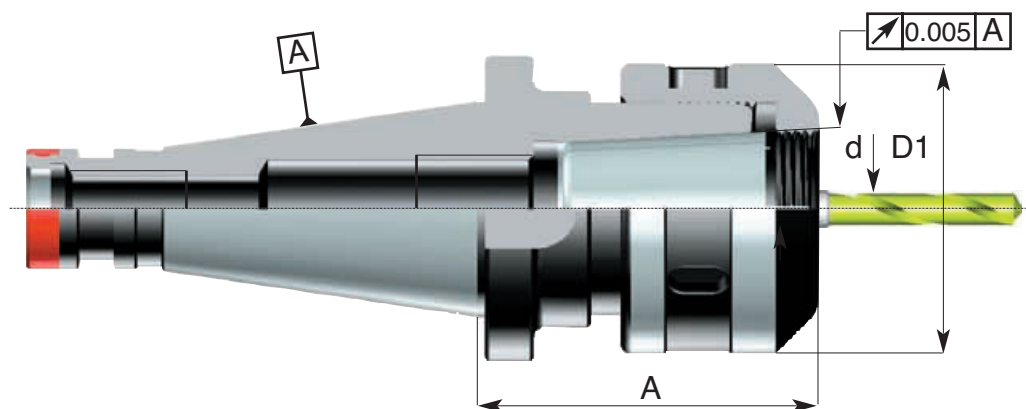

Codice di ord Code	SK	A	D1	Cap. di chiusura Pinza "d" Capacity range "d"	Tipo pinza Collet	Ghiera Nut
200.30.0260	SK 30	63	50	da 3 a 18	209.10	245.01
200.40.0320	SK 40	70	58	da 3 a 22	209.20	245.02
200.40.0440	SK 40	79	73	da 4 a 32	209.30	245.03
200.50.0320	SK 50	70	58	da 3 a 22	209.20	245.02
200.50.0440	SK 50	75	73	da 4 a 32	209.30	245.03
200.60.0440	SK 60	95	73	da 4 a 32	209.30	245.03

Cassette con mandrini per pinze Delta rif. art.209  
 Boxes with Delta collet chucks and collets ref. art.209  
 Kassetten mit Spannzangenhalter Delta und Spannzangen ref. art.209  
 Coffrets avec mandrins à pinces Delta et pinces ref. art.209

DIN 2080

### CASSETTE 15

ART: 202

5.  
19



Codice di ord. Code	Mandrino Chuck	SK	Tipo pinza Collets type	Numero pinze Collets nr.	Ø Pinza Ø Collets
15.01	200.30.0260	ISO 30 DIN 2080	209.10	7	3-4-6-8-10-12-16
15.02	200.30.0260	ISO 30 DIN 2080	209.10	14	da 3 a 16
15.05	200.40.0320	ISO 40 DIN 2080	209.20	7	4-6-8-10-12-16-20
15.06	200.40.0320	ISO 40 DIN 2080	209.20	18	da 3 a 20
15.07	200.40.0440	ISO 40 DIN 2080	209.30	9	4-6-8-10-12-16-20-25-32
15.08	200.40.0440	ISO 40 DIN 2080	209.30	28	da 4 a 32
15.09	200.50.0440	ISO 50 DIN 2080	209.30	9	4-6-8-10-12-16-20-25-32
15.10	200.50.0440	ISO 50 DIN 2080	209.30	28	da 4 a 32

## 5. MANDRINI a cono ISO DIN 2080

TOOL HOLDERS with ISO cone DIN 2080



Mandrini portapinze EOC tipo normale e prolungato DIN 6388

Collet chucks EOC - DIN 6388

Spannzangenhalter EOC - DIN 6388

Mandrins porte-pinces EOC - DIN 6388

ACCESSORI PER MACCHINE UTENSILI



DIN 2080

ART: 601

5.  
20

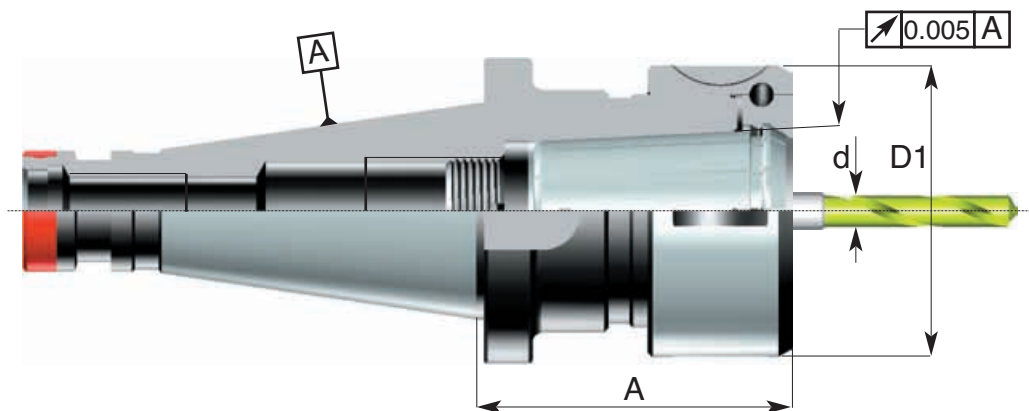

Pinze / Collets  
pag: 12.4

Ghiere / Nuts  
pag: 12.14

Codice di ord Code	SK	EOC	A	D1	Cap. di chiusura Pinza "d" Capacity range "d"	Ghiera Nut
601.40.0350	SK 40	25	70	60	da 3 a 25	245.48.0350
601.40.0352	SK 40	25	120	60	da 3 a 25	245.48.0350
601.40.0440	SK 40	32	70	72	da 4 a 32	245.60.0440
601.40.0442	SK 40	32	120	72	da 4 a 32	245.60.0440
601.50.0350	SK 50	25	75	60	da 3 a 25	245.48.0350
601.50.0352	SK 50	25	120	60	da 3 a 25	245.48.0350
601.50.0440	SK 50	32	80	72	da 4 a 32	245.60.0440
601.50.0442	SK 50	32	120	72	da 4 a 32	245.60.0440

ACCESSORI PER MACCHINE UTENSILI



Mandrini "GNUTTI" portapinze ER DIN 6499 - ghiera standard  
 Collet chucks "GNUTTI" ER DIN 6499 - standard nut  
 Spannzangenhalter "GNUTTI" ER DIN 6499 - standard Spannmutter  
 Mandrins porte-pinces "GNUTTI" ER DIN 6499 - écrou standard

**GNUTTI**

**ART: GNU.607**  
 ghiera standard / standard nut

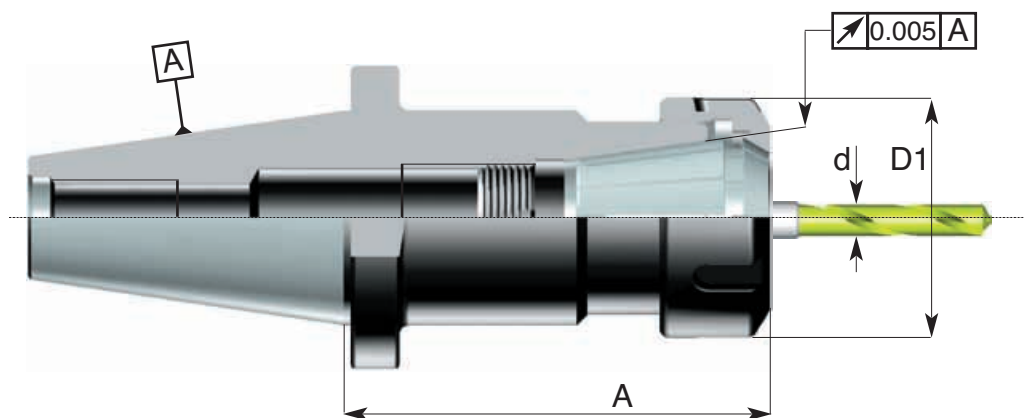

**5.**  
**21**



Codice di ord Code	SK	ER	A	D1	Cap. di chiusura Pinza "d" Capacity range "d"	Ghiera Nut
GNU.60730032050	SK 30	ER32	50	50	da 1 a 20	245.40.ER32
GNU.60730032070	SK 30	ER32	70	50	da 1 a 20	245.40.ER32
GNU.60730032080	SK 30	ER32	80	50	da 1 a 20	245.40.ER32
GNU.60730032090	SK 30	ER32	90	50	da 1 a 20	245.40.ER32
GNU.607300320100	SK 30	ER32	100	50	da 1 a 20	245.40.ER32
GNU.607300320110	SK 30	ER32	110	50	da 1 a 20	245.40.ER32
GNU.60730040070	SK 30	ER40	70	63	da 2 a 30	245.50.ER40
GNU.60730040080	SK 30	ER40	80	63	da 2 a 30	245.50.ER40
GNU.60730040090	SK 30	ER40	90	63	da 2 a 30	245.50.ER40
GNU.607300400100	SK 30	ER40	100	63	da 2 a 30	245.50.ER40
GNU.607300400110	SK 30	ER40	110	63	da 2 a 30	245.50.ER40
GNU.60740032070	SK 40	ER32	70	50	da 1 a 20	245.40.ER32
GNU.60740032090	SK 40	ER32	90	50	da 1 a 20	245.40.ER32
GNU.607400320100	SK 40	ER32	100	50	da 1 a 20	245.40.ER32
GNU.607400320120	SK 40	ER32	120	50	da 1 a 20	245.40.ER32
GNU.607400320150	SK 40	ER32	150	50	da 1 a 20	245.40.ER32
GNU.60740040070	SK 40	ER40	70	63	da 2 a 30	245.50.ER40
GNU.60740040090	SK 40	ER40	90	63	da 2 a 30	245.50.ER40
GNU.607400400100	SK 40	ER40	100	63	da 2 a 30	245.50.ER40
GNU.607400400120	SK 40	ER40	120	63	da 2 a 30	245.50.ER40

## 5. MANDRINI a cono ISO DIN 2080

### TOOL HOLDERS with ISO cone DIN 2080



Mandrini portapinzine ER DIN 6499 - ghiera standard  
 Collet chucks ER DIN 6499 - standard nut  
 Spannzangenhalter ER DIN 6499 - standard Spannmutter  
 Mandrins porte-pinces ER DIN 6499 - écrou standard

ACCESSORI PER MACCHINE UTENSILI

DIN 2080



**ART: 607**  
 ghiera standard / standard nut

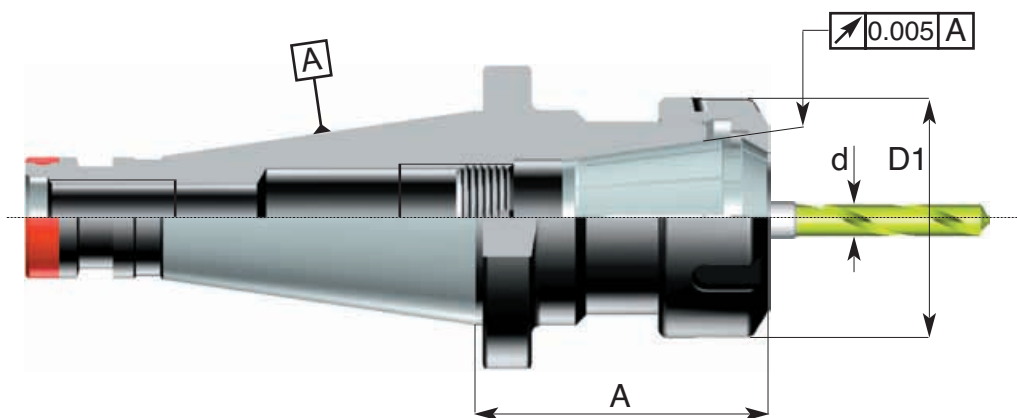

Codice di ord Code	SK	ER	A	D1	Cap. di chiusura Pinza "d" Capacity range "d"	Ghiera Nut
607.30.0250	SK 30	ER 25	50	42	da 1 a 16	245.32.ER25
607.30.0252	SK 30	ER 25	90	42	da 1 a 16	245.32.ER25
607.30.0320	SK 30	ER 32	50	50	da 1 a 20	245.40.ER32
607.30.0320.A	SK 30	ER 32	60	50	da 1 a 20	245.40.ER32
607.30.0321	SK 30	ER 32	70	50	da 1 a 20	245.40.ER32
607.30.0321.A	SK 30	ER 32	80	50	da 1 a 20	245.40.ER32
607.30.0322	SK 30	ER 32	90	50	da 1 a 20	245.40.ER32
607.30.0323	SK 30	ER 32	100	50	da 1 a 20	245.40.ER32
607.30.0323.A	SK 30	ER 32	110	50	da 1 a 20	245.40.ER32
607.30.0324	SK 30	ER 32	120	50	da 1 a 20	245.40.ER32
607.30.0400	SK 30	ER 40	70	63	da 2 a 30	245.50.ER40
607.30.0401	SK 30	ER 40	80	63	da 2 a 30	245.50.ER40
607.30.0401.A	SK 30	ER 40	90	63	da 2 a 30	245.50.ER40
607.30.0402	SK 30	ER 40	100	63	da 2 a 30	245.50.ER40
607.40.0160	SK 40	ER 16	60	28	da 0,5 a 10	245.22. ER16
607.40.0162	SK 40	ER 16	120	28	da 0,5 a 10	245.22. ER16
607.40.0200	SK 40	ER 20	60	34	da 0,5 a 13	245.25.ER20
607.40.0202	SK 40	ER 20	120	34	da 0,5 a 13	245.25.ER20
607.40.0250	SK 40	ER 25	60	42	da 1 a 16	245.32.ER25
607.40.0252	SK 40	ER 25	120	42	da 1 a 16	245.32.ER25
607.40.0320.C	SK 40	ER 32	50	50	da 1 a 20	245.40.ER32
607.40.0320	SK 40	ER 32	60	50	da 1 a 20	245.40.ER32
607.40.0320.A	SK 40	ER 32	80	50	da 1 a 20	245.40.ER32
607.40.0320.90	SK 40	ER 32	90	50	da 1 a 20	245.40.ER32
607.40.0321	SK 40	ER 32	100	50	da 1 a 20	245.40.ER32
607.40.0321.A	SK 40	ER 32	110	50	da 1 a 20	245.40.ER32
607.40.0322	SK 40	ER 32	120	50	da 1 a 20	245.40.ER32
607.40.0324	SK 40	ER 32	150	50	da 1 a 20	245.40.ER32
607.40.0400	SK 40	ER 40	60	63	da 2 a 30	245.50.ER40
607.40.0401.A	SK 40	ER 40	100	63	da 2 a 30	245.50.ER40
607.40.0402	SK 40	ER 40	120	63	da 2 a 30	245.50.ER40
607.40.0404	SK 40	ER 40	150	63	da 2 a 30	245.50.ER40
607.50.0250	SK 50	ER 25	70	42	da 1 a 16	245.32.ER25
607.50.0252	SK 50	ER 25	120	42	da 1 a 16	245.32.ER25
607.50.0320	SK 50	ER 32	70	50	da 1 a 20	245.40.ER32
607.50.0322	SK 50	ER 32	120	50	da 1 a 20	245.40.ER32
607.50.0400	SK 50	ER 40	70	63	da 2 a 30	245.50.ER40
607.50.0402	SK 50	ER 40	120	63	da 2 a 30	245.50.ER40

Cassette con portapinze ER pinze complete di chiave di serraggio  
 Boxes with ER collet chucks and collets - supplied with wrench  
 Kassetten mit Spannzangenhalter ER und Spannzangen - geliefert mit Schlüssel  
 Coffrets avec mandrins à pinces ER et pinces - fournis avec clé

DIN 2080

**CASSETTE DIN 2080**  
**ART: 607...**

5.  
23



Codice di ord. Code	Mandrino Chuck	SK	Tipo pinza Collets type	Numero pinze Collets nr.	Ø Pinza Ø Collets
<b>30.09.ER32</b>	607.30.0320	ISO 30 DIN 2080	ER32	9	4-6-8-10-12-14-16-18-20
<b>30.18.ER32</b>	607.30.0320	ISO 30 DIN 2080	ER32	18	da 3 a 20
<b>40.09.ER32</b>	607.40.0320	ISO 40 DIN 2080	ER32	9	4-6-8-10-12-14-16-18-20
<b>40.18.ER32</b>	607.40.0320	ISO 40 DIN 2080	ER32	18	da 3 a 20
<b>40.09.ER40</b>	607.40.0400	ISO 40 DIN 2080	ER40	9	4-6-8-10-12-14-16-18-20
<b>40.23.ER40</b>	607.40.0400	ISO 40 DIN 2080	ER40	23	da 4 a 26
<b>50.09.ER32</b>	607.50.0320	ISO 50 DIN 2080	ER32	9	4-6-8-10-12-14-16-18-20
<b>50.18.ER32</b>	607.50.0320	ISO 50 DIN 2080	ER32	18	da 3 a 20
<b>50.09.ER40</b>	607.50.0400	ISO 50 DIN 2080	ER40	9	4-6-8-10-12-14-16-18-20
<b>50.23.ER40</b>	607.50.0400	ISO 50 DIN 2080	ER40	23	da 4 a 26

## 5. MANDRINI a cono ISO DIN 2080

TOOL HOLDERS with ISO cone DIN 2080



Mandri per astucci registrabili e portautensili con gambo a norma din 6327

Adaptors for adjustable inserts DIN 6327

Zwischenhülsen für axialverstellbare Futter DIN 6327

Douilles pour mandrins réglables axialement DIN 6327

ACCESSORI PER MACCHINE UTENSILI



DIN 2080

ART: 610

5.  
24

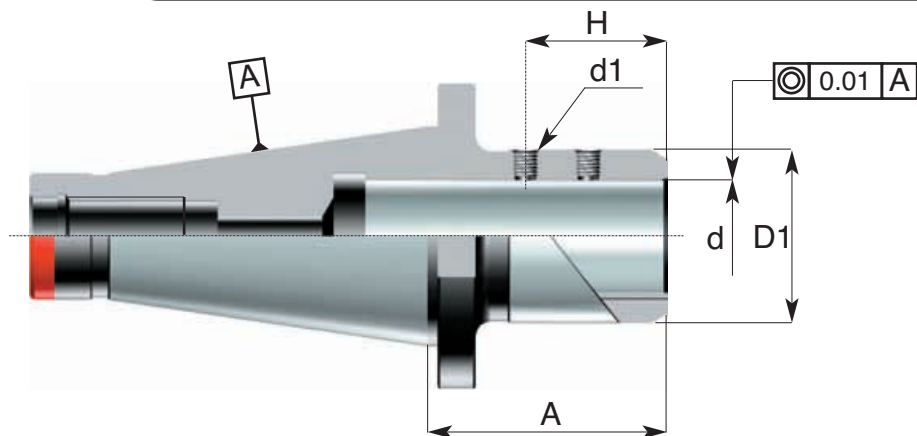
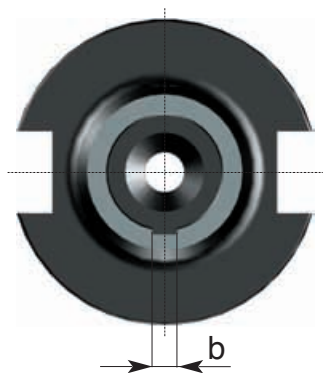

Codice di ord Code	SK	d h7	A	D1	H	b C11	Grano di serraggio "d1" Clamping screw "d1"
610.40.0250	SK 40	25	65	37	38	6	610.00.0060
610.40.0280	SK 40	28	70	40	38	6	610.00.0060
610.40.0320	SK 40	32	110	45	45	8	610.00.0080
610.40.0360	SK 40	36	115	50	45	8	610.00.0080
610.50.0280	SK 50	28	70	40	38	6	610.00.0080
610.50.0320	SK 50	32	70	45	45	8	610.00.0080
610.50.0360	SK 50	36	70	50	45	8	610.00.0080
610.50.0480	SK 50	48	100	67	57	10	610.00.0100





ACCESSORI PER MACCHINE UTENSILI



Maschiatori a cambio rapido con compensazione elastica assiale a trazione e pressione  
*uick-change tapping chuck with compensation in compression and tension*  
*Gewindeschneid- und Schnellwechselfutter mit Ausgleich auf Druck und Zug*  
*Mandrin à tarauder à changement rapid avec compensation longitudinale et de la traction*

DIN 2080

ART: 638

5.  
25

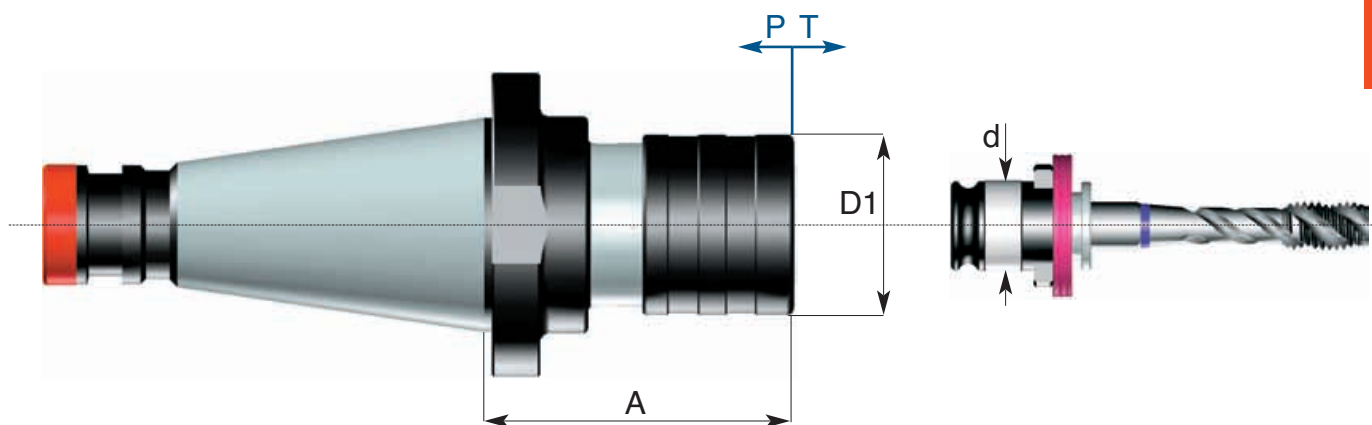

Codice di ord <i>Code</i>	SK	A	D1	d	Capacità maschiatore <i>Tapping capacity</i>	Compensazione assiale <i>T Axial compensation P</i>	
638.30.1205	SK 30	60	36	19	M3 - M14	5	7
638.40.1205	SK 40	60	36	19	M3 - M14	5	7
638.40.2008	SK 40	85	53	31	M8 - M24	12	13
638.50.1205	SK 50	70	36	19	M3 - M14	5	7
638.50.2008	SK 50	95	53	31	M8 - M24	12	12
638.50.3310	SK 50	130	78	48	M14 - M36	15	20



## 5. MANDRINI a cono ISO DIN 2080

TOOL HOLDERS with ISO cone DIN 2080



Cilindro di collaudo certificato

Test arbors with test certificate

Kontrolldorne mit Prüfungszeugnis

Mandrins de contrôle avec certificat de bon fonctionnement

ACCESSORI PER MACCHINE UTENSILI



DIN 2080

ART: 808

5.  
26

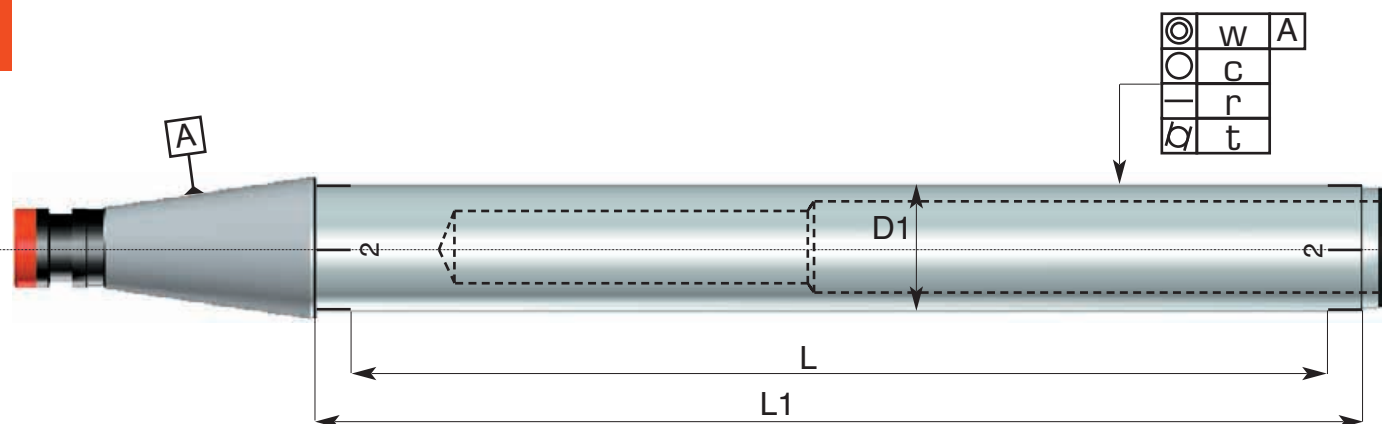

Codice di ord Code	SK	D1 H5	L	L1	w	c	r	t
808.30.0320	SK 30	32	200	225	0.003	0.003	0.003	0.003
808.40.0400	SK 40	40	300	337	0.004	0.003	0.003	0.003
808.50.0400	SK 50	40	300	338	0.003	0.003	0.003	0.003
808.50.0630	SK 50	63	500	538	0.004	0.004	0.003	0.003



[www.delta-spa.com](http://www.delta-spa.com)



PORTAUTENSILI A CONO ISO DIN 2088 E MORSE PER MACCHINE UTENSILI TRADIZIONALI  
CONTROPUNTE ROTANTI E FISSE - MANDRINI MASCHIATORI A CAMBIO RAPIDO  
TOOLHOLDERS FOR MILLING AND BORING MACHINES WITH ISO AND MORSE  
PRECISION RUNNING TAIL CENTERS - QUICK CHANGE TAPPING CHUCKS

PORTAUTENSILI A CONO ISO DIN 69871/A-B, CAT E MAS BT 405 PER CENTRI DI LATO  
A CONTROLLO NUMERICO  
TOOLHOLDERS FOR CNC MACHINERY WITH ISO DIN 69871/A-B, CAT AND MAS BT 405

PORTAUTENSILI CON ATTACCO HSK DIN 69893 FORMA A -  
TOOLHOLDERS WITH HSK TAPER DIN 69893 FORM A -

MANDRINO HYDRO DELTA A CHIUSURA IDRAULICA  
HYDRO DELTA CHUCKS HYDRAULIC CLAMP

PORTAUTENSILI PER TORNI A CONTROLLO NUMERICO DIN 69880 UDI 3  
TOOLHOLDERS FOR NC LATHES DIN 69880 UDI 3

MANDRINI MACCHINA PRINCIPALI - PORTAUTENSILI SPECIALI A DISEGNO CLIENTI  
MACHINE MAIN SPINDLES - SPECIAL TOOLHOLDERS ON CUSTOMER'S REQUEST

## **6.2**

- cambio rapido "DELTA RAPID"  
*Quick change device "DELTA RAPID"*

## **6.3**

- cambio rapido "DELTA RAPID"  
*Quick change device "DELTA RAPID"*

## **6.4**

- cambio rapido "DELTA RAPID"  
*Quick change device "DELTA RAPID"*

## **6.5**

- cambio rapido "DELTA RAPID"  
*Quick change device "DELTA RAPID"*



**DELTA RAPID**  
**Cambi rapidi**  
*Quick change device*

6

 **delta**

## 6. CAMBI RAPIDI DELTA

### QUICK CHANGE DEVICES



Dispositivo di cambio rapido "DELTA RAPID" per fresatrici-alesatrici

Quick change device "Delta Rapid" for milling and boring machines

Schnellwechseinrichtung "Delta Rapid" für Bohr- und Fräsmaschinen

Dispositif pour changement rapide d'outillages "Delta Rapid" pour fraiseuses et aléseuses

ACCESSORI PER MACCHINE UTENSILI



ART: 100

Naso mandrino DIN 2078

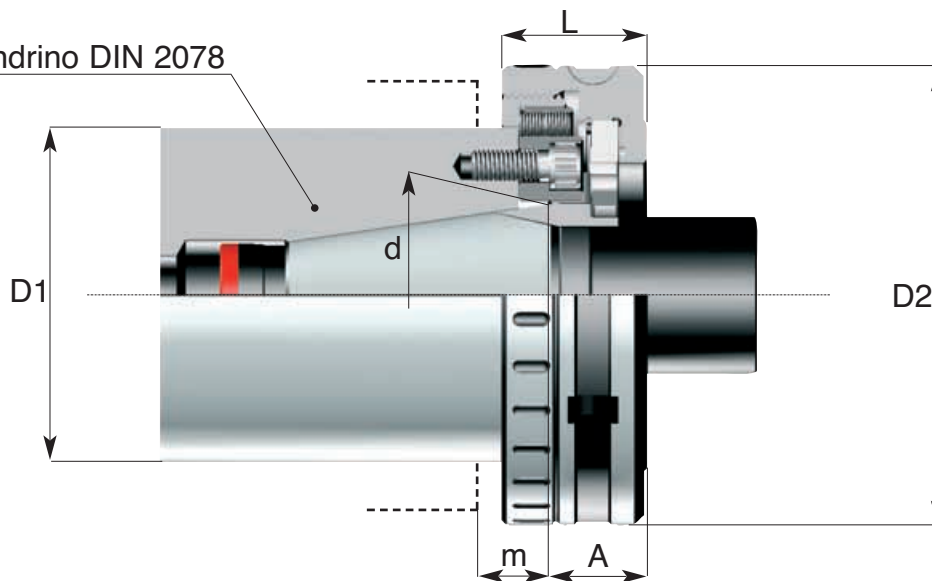

Codice di ord Code	SK	d	D1 h5	D2	m	A	L
<b>100.30.0300</b>	SK 30	31.750	69.832	103	12.5	26	38
<b>100.40.0400</b>	SK 40	44.450	88.882	129	16	30	46
<b>100.50.0500</b>	SK 50	69.850	128.570	178	19	38	56

**ACCESSORI PER MACCHINE UTENSILI**

Dispositivo di cambio rapido "DELTA RAPID" da cono ISO a cono ISO per fresatrici-alesatrici  
 Quick change device "Delta Rapid" ISO to ISO cone for milling and boring machines  
 Schnellwechseinrichtung "Delta Rapid" Steilkegel ISO zu ISO für Bohr- und Fräsmaschinen  
 Dispositif pour chang. rapid "Delta Rapid" cône ISO à ISO pour fraiseuses et aléseuses



**DIN 2080**

**ART: 102**

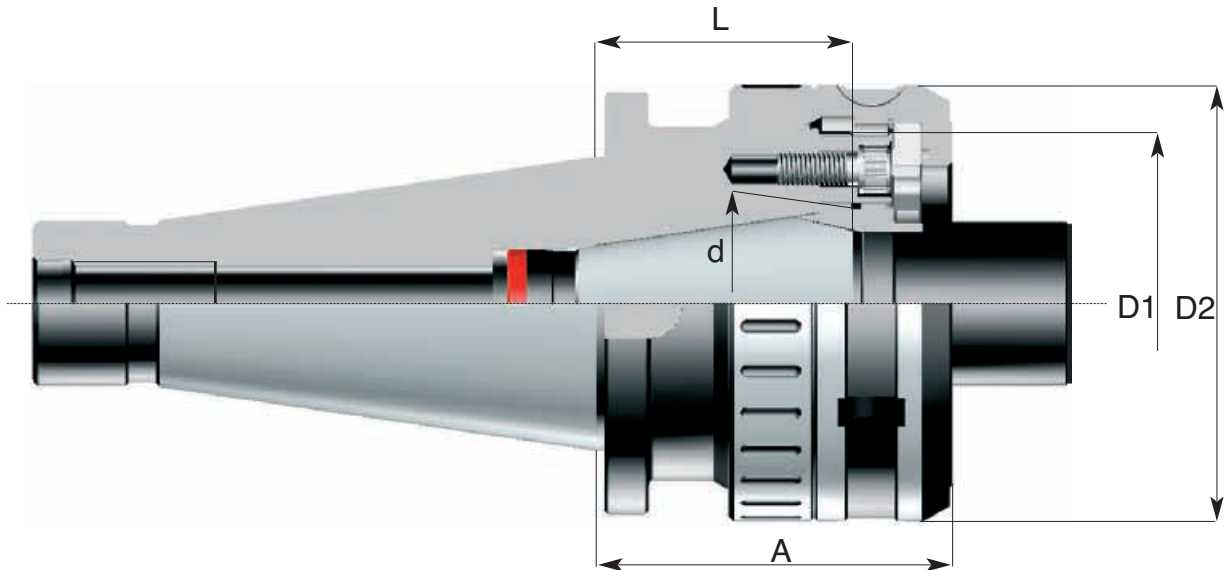

**6.**  
**3**

Codice di ord Code	SK ext. DIN 2080	SK int. DIN 2080	d	D1 h5	D2	L	A
<b>102.40.0300</b>	SK 40	SK 30	31.750	69.832	92	45	70
<b>102.40.0400</b>	SK 40	SK 40	44.450	88.882	118	78	105
<b>102.45.0400</b>	SK 45	SK 40	44.450	88.882	118	60	90
<b>102.50.0400</b>	SK 50	SK 40	44.450	88.882	118	60	90
<b>102.50.0500</b>	SK 50	SK 50	69.850	128.570	158	100	130
<b>102.60.0500</b>	SK 60	SK 50	69.850	128.570	158	80	117

## 6. CAMBI RAPIDI DELTA

### QUICK CHANGE DEVICES



Dispositivo di cambio rapido "Delta" da cono Morse e Metrico a cono ISO

"Delta" quick change device from metric and Morse to ISO cone

Schnellwechseleinrichtung "Delta" von Morse und metrischem Kegel zu Steilkegel ISO

Dispositif de blocage et déblochage rapide "Delta" de cône Morse et metrique à ISO

ACCESSORI PER MACCHINE UTENSILI



DIN 228 B

ART: 105

6,  
4

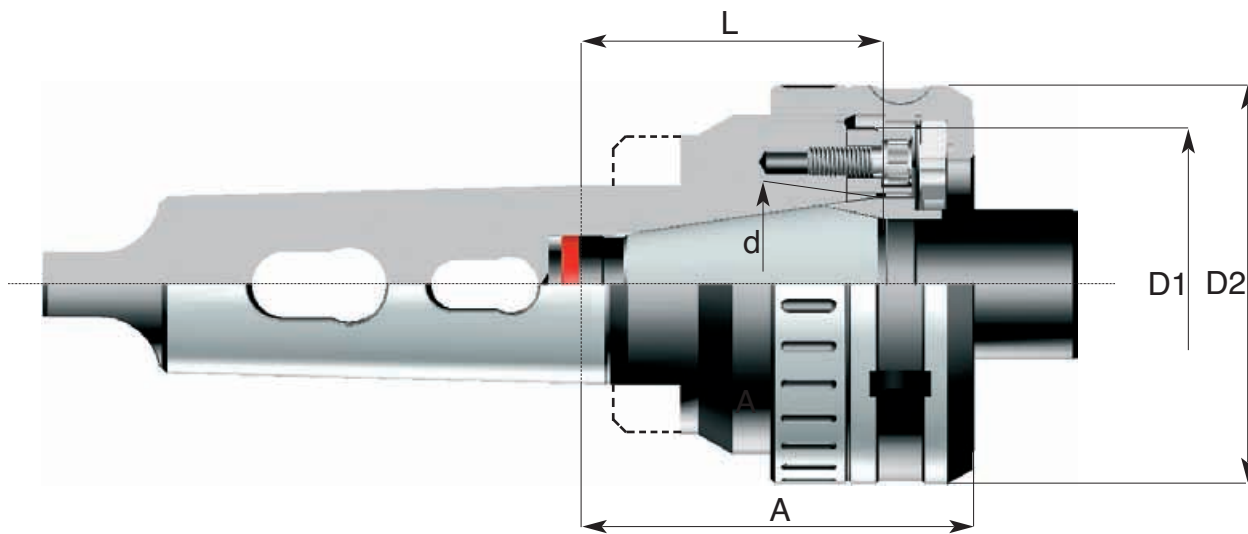

Codice di ord Code	SK ext. DIN 2080	SK int. DIN 2080	d	D1 h5	D2	L	A
105.05.0400	Morse 5	SK 40	44.450	88.882	118	78	105
105.06.0500	Morse 6	SK 50	69.850	128.570	158	115	152
105.08.0400	Metr. 80	SK 40	44.450	88.882	118	95	123
105.08.0500	Metr. 80	SK 50	69.850	128.570	158	115	152
105.10.0500	Metr. 100	SK 50	69.850	128.570	158	125	162
105.12.0500	Metr. 120	SK 50	69.850	128.570	158	122	159



#### ACCESSORI PER MACCHINE UTENSILI

Dispositivo di cambio rapido "Delta" con ISO con attacco a flangia secondo DIN 2079  
 "Delta " quick change device with ISO cone and DIN 2079 flanged coupling  
 Schnellwechseinrichtung "Delta " mit Befestigungsflanschsteigekegel DIN 2079  
 Dispositif de blocage et débloccage rapide "Delta" à cône ISO avec système d'attaque à bride DIN 2079



**ART: 108**

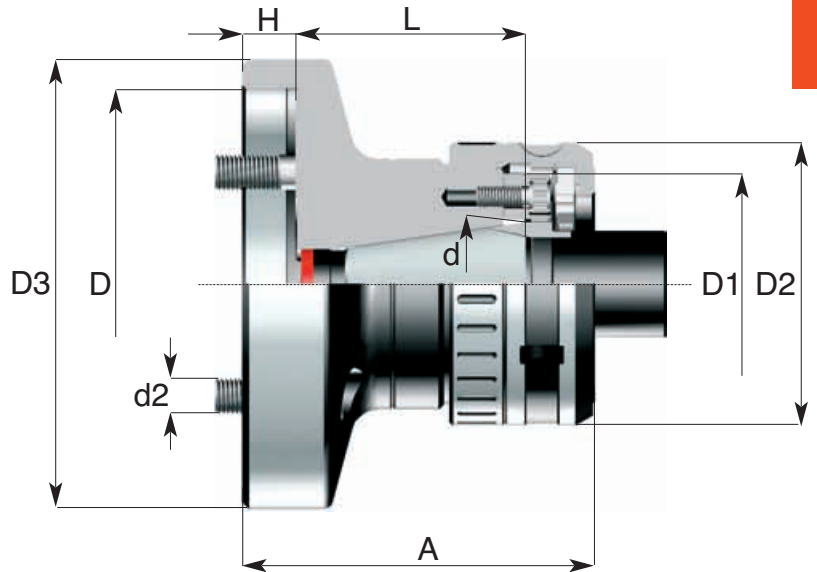
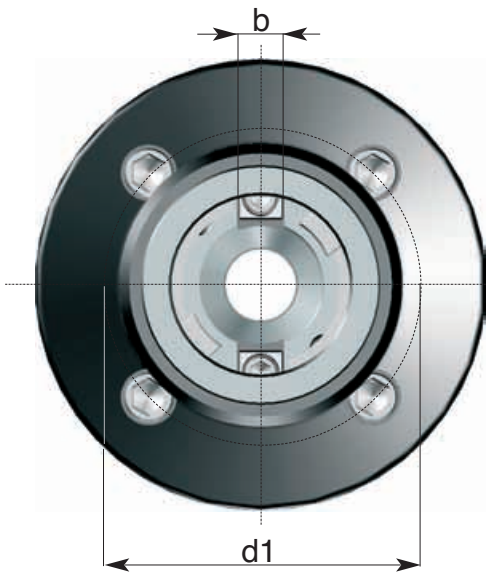

6.  
5

Codice di ord Code	SK int.	d	D H6	D1 h5	D2	D3	L	A	H	d1	d2	b
<b>108.40.1280</b>	SK 40	44.450	128.570	88.882	118	160	101	149	20	101.60	M16	25.4
<b>108.50.1280</b>	SK 50	69.850	128.570	128.570	158	168.5	131	187	20	101.60	M16	25.4